



**STAND OUT
GRAPHICS
PACKAGE**



DESERT FOX

Desert Fox	21SW	24AS	27FS	29SB
Dry Axle Weight (approx lbs)	5365	TBA	6301	6552
Dry Hitch Weight (approx lbs)	898	TBA	1238	1463
Net Carrying Capacity (approx lbs)	4137	TBA	4461	5985
Gross Dry Weight (approx lbs)	6263	TBA	7539	8015
Gross Vehicle Weight Rating (GVW) - lbs	10400	TBA	12000	14000
Exterior Length (approx w/ hitch)	25'0"	30'2"	32'7"	33'7"
Exterior Height (approx w/o A/C)	11'4"	11'7"	11'7"	11'7"
Exterior Width (approx w/o Awning)	8'6"	8'6"	8'6"	8'6"
Tire Size	ST235 80R16	ST235 80R16	ST235 80R16	ST235 80R16
Load Range	E	E	E	E
Fresh Water Capacity (approx gal)	78	100	100	100
Gray Water Tank (approx gal)	46	47	47	47
Black Water Tank (approx gal)	37	50	50	50
LPG Capacity (approx gal)	14	14	14	14
CSA - Canadian Dealers Only	Yes	Yes	Yes	Yes
Auto Ignition Furnace (1,000 BTU's)	25	30	30	30



**OPTIONAL:
CONVERT-A-U DINETTE/LOUNGE
WITH ELECTRIC LIFT
AND OPTIONAL UPPER BUNK**



BRONZE INTERIOR



STONE INTERIOR



**MARINE TOILET
WITH FOOT PEDAL**



QUEEN SIZE BED



More D-Fox

DESERT FOX

KICKER SOUND SYSTEM

FULL FUNCTIONING KITCHEN

SWIVEL ROCKERS

SOFFIT LIGHTING AND CARGO NET STORAGE

STAINLESS STEEL APPLIANCES

EXTRA STORAGE

STONE INTERIOR

RESIDENTIAL FACE FRAME CABINETRY

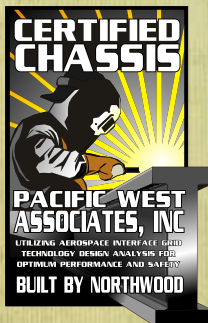

- Aluminum Frame/Fully Laminated Construction
- R-18 Insulated Roof/R-7 Walls and Floor
- Northwood Built Certified Structural Steel Chassis
- Solar Reflective Windows
- Stainless Steel Appliances
- Rubber Cargo Area Decking
- Diamond Plate Front Protection
- Shock Absorbers on All 4 Wheels
- Interior Command Center
- Electric Awning
- Large Skylight with Shade
- Cargo Netted Overhead Storage
- Kicker Premium Sound System with Amp
- 16" Aluminum Wheels/Tires/Chassis Under Mounted Spare (most models)

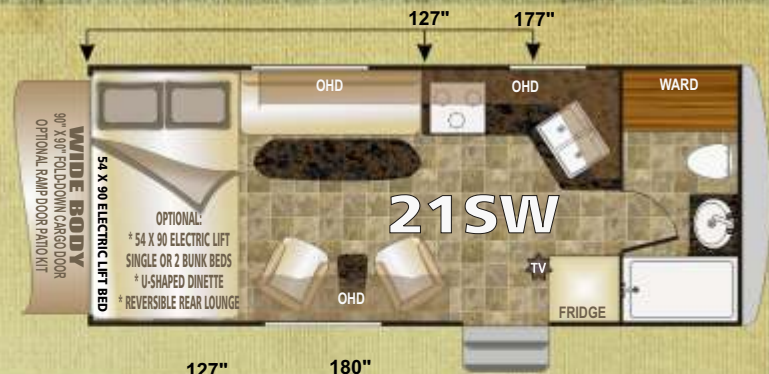

MADE TO PLAY HARD